



**NEW** **510SX**

NEW STYLE. CLASSIC INTEGRITY.  
**AVAILABLE TO ORDER NOW**



**INTEGRITY**  
**MOTOR YACHTS**

**DISCOVER MORE**

PART OF THE WHITEHAVEN MOTOR YACHTS FAMILY





**DISCOVER MORE**

## INTRODUCING THE INTEGRITY SX RANGE

Complementing the Classic Integrity Motor Yachts, the new SX range features a slew of exterior styling modifications designed by leading Naval Architect & Designer Misha Merzliakov, to appeal to a new generation of boating families.

While maintaining the key Integrity DNA of spacious entertainer's layouts, undercover cockpit and side walkways for easy access, as well as reliable and economical displacement cruising, the new SX range – comprising 340 SX, 380 SX and 460 SX models – will embody an enhanced elegance, blending the timeless appeal of traditional trawler style attributes with mid-century automotive cues, sophisticated geometry and a variety of materials.

Building on the single engine reliability and efficiency all Integrity motor yachts deliver, the SX range will offer electronic engine options.

The new SX Range is a deliberate and successful fusion of the classic lines Integrity is renowned for and contemporary stylistic elements that will be attractive to young families and hip Baby Boomers, adding to their ability to personalize their Integrity.



**INTEGRITY**  
MOTOR YACHTS

DISCOVER MORE

**340SEDAN 340SX 380SEDAN 380FB 380SX 440SEDAN 440FB 460SX 490GRANDSEDAN 510SX**

QUEENSLAND  
Integrity Motor Yachts  
Jason Kowalski 0416 057 326

NEW SOUTH WALES  
AWMarine Sales  
Adam Workman 0419 124 939

VICTORIA  
Pier 35 Boat Sales  
Terry Ryan 0422 666 212

WESTERN AUSTRALIA  
Martin Box Marine  
Phone 08 9336 1466

TASMANIA  
Boat Sales Tasmania  
Paul Nanscawen 0418 385 866

[www.integrityboats.com.au](http://www.integrityboats.com.au)

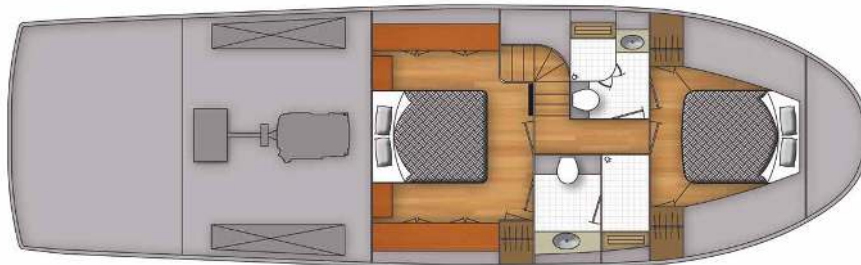
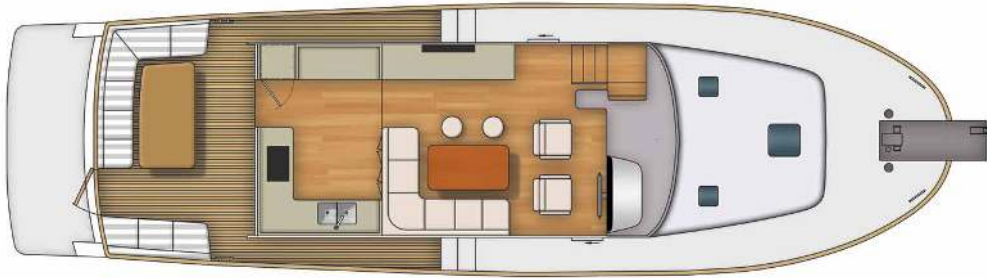
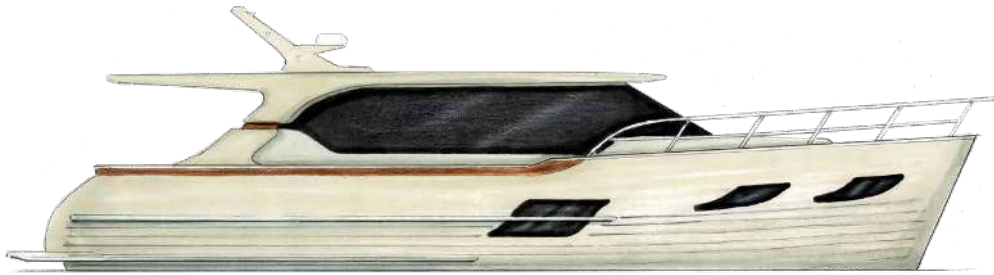

**NEW** **510SX**

Length Overall (inc, swim platform)	16.0m (52' 4")
Beam	4.6m (15' 0")
Maximum Draft approx	1.4m (4' 6")
Sleeping Capacity	6 person
Fuel Capacity approx.	2,000 litres
Water Capacity approx.	700 litres
Holding Tank Capacity approx.	200 litres
Engine	Cummins QSB 6.7 480hp



**INTEGRITY**  
MOTOR YACHTS

DISCOVER MORE

Version: 02/10/19

**340SEDAN 340SX 380SEDAN 380FB 380SX 440SEDAN 440FB 460SX 490GRANDSEDAN 510SX**

QUEENSLAND  
Integrity Motor Yachts  
Jason Kowalski 0416 057 326

NEW SOUTH WALES  
AWMarine Sales  
Adam Workman 0419 124 939

VICTORIA  
Pier 35 Boat Sales  
Terry Ryan 0422 666 212

WESTERN AUSTRALIA  
Martin Box Marine  
Phone 08 9336 1466

TASMANIA  
Boat Sales Tasmania  
Paul Nanscawen 0418 385 866

[www.integrityboats.com.au](http://www.integrityboats.com.au)

# 510SX

## BASE SPECIFICATION

### MECHANICAL & ELECTRICAL

Acoustic and thermal insulation throughout engine room  
Non-skid flooring in engine room  
Freshwater cooling on engine  
Engine alarm system  
Racor fuel filter  
Anti-vibration engine mounts  
Fibreglass exhaust system for engine  
Fibreglass Aqualift exhaust for generator  
Ventilation system includes blowers for engine room  
Stainless steel propeller shaft  
Dripless PSS shaft seal  
Steering stock  
Rudder locking pin  
Bronze propeller  
Bronze Seawater strainers for engine, genset & aircon  
Bow Thruster 24V 8HP  
Stern Thruster 24V 8HP  
Full keel, GRP Rudder  
All hoses double hose clamped below waterline  
Ball valves on all seacocks and skin fittings  
Hot water heater 40 Litres  
Bilge pumps auto with manual override and high water alarms x 3  
Manual bilge pump system  
Fresh water pressure pump high volume 24v  
Seawater pump for foredeck and cockpit 24v  
Sanitation system with macerator pump out and deck fitting for dock side pump out  
Generator 9kW  
Battery charger/inverter 24v 3kva  
House Batteries- 400Ahr 24VDC, maintenance free  
Engine Batteries -110Ahr 24VDC, Genset Battery 110Ahr 24VDC  
All batteries fitted in GRP battery boxes  
Battery paralleling system for emergency engine start  
LED lighting throughout 24v  
Engine room lighting DC  
Navigation lights LED international compliant  
All AC power outlets RCD protected  
Bonding system to hull fittings, zinc anode incl. isolator  
Tinned electrical wiring. Where applicable coded and labelled  
Electrical panel DC with circuit breakers.  
Shore power lead 1 x 15Amp adaptor

Fusion Stereo / DVD player with bluetooth

Fusion speakers

### SALOON HELM

Helm bench seat, including footrest and storage underneath

Console for instruments

Full engine controls, compass, anchor winch controls

Safety monitor panel for bilge pumps, sump pump

Stainless steel steering wheel leather wrapped

VHF radio with aerial

Horn electric

Hydraulic steering

Fuel and Water gauges

### STATEROOM - FORWARD

Flooring high quality vinyl

Double berth with foam mattress

Hanging locker

Escape deck hatch from forward cabin stainless steel

Ocean air hatch cover with screen and blind

Reading and overhead lighting LED 24v (DC)

Private entrance door

Storage under berth

Opening porthole stainless steel x 2

### STATEROOM - MIDSHIPS

Full beam cabin with queen size bed

Private ensuite with shower

Flooring high quality vinyl

Double berth with foam mattress

Hanging locker

Opening portholes - stainless steel

Reading and overhead lighting (DC)

Private door entrance

Storage under berth

Storage locker drawers

Mirror Hanging locker with drawers

### CONSTRUCTION

Moulded GRP hull white gelcoat

Hull top sides reinforced for light weight

Independent compartments and stringer system



DISCOVER MORE

Version: 02/10/19

340SEDAN 340SX 380SEDAN 380FB 380SX 440SEDAN 440FB 460SX 490GRANDSEDAN 510SX

QUEENSLAND  
Integrity Motor Yachts  
Jason Kowalski 0416 057 326

NEW SOUTH WALES  
AWMarine Sales  
Adam Workman 0419 124 939

VICTORIA  
Pier 35 Boat Sales  
Terry Ryan 0422 666 212

WESTERN AUSTRALIA  
Martin Box Marine  
Phone 08 9336 1466

TASMANIA  
Boat Sales Tasmania  
Paul Nanscawen 0418 385 866

[www.integrityboats.com.au](http://www.integrityboats.com.au)

# 510SX

## BASE SPECIFICATION

Solid hull bottom with chines to waterline  
Vinyl ester resin used in first two outer layers of hull  
Water tight collision bulkhead forward  
Water tight light weight cored bulkheads/flooring  
White hull colour standard/inc boot stripe

### DECK

Anchor 45lbs, 60mtrs of chain  
Anchor locker accessed by 2 hatches on deck  
Anchor safety strap  
Bow rail welded stainless (316) flag staff at bow  
Bow roller stainless self loading  
Cleats stainless steel x 6, (Bow x 2, Spring x 2, and Stern x 2)  
Docking lines and fenders x 4  
Escape deck hatch from forward cabin stainless steel  
Exterior courtesy deck lights  
Fuel fillers on side decks  
Fwd windscreen in safety glass bonded to FRP frames  
Rub Rail with stainless steel insert  
Winch 24V with foot switches  
Non slip on fwd & deck sides  
Sliding Side door to FRP house frame  
Stainless steel swim ladder  
Wash down tap (sea water & fresh) in anchor locker

### COCKPIT

Aft seat with teak table  
Access hatch lockable  
Flood lights, overhead lighting & courtesy DC  
Hand held shower hot/cold  
Stainless framed main saloon entrance door with hopper window  
Stainless steel grab rails  
Teak laid cockpit floor  
Wash down tap, fresh water  
Cockpit storage under seating  
GRP 1200mm swim platform with teak inserts  
Shore power inlet located in cockpit locker

### HEAD

Private entrance door  
Overhead and vanity lighting LED 24v (DC)  
Opening porthole stainless steel  
Solid benchtop surface including basin and single lever faucet  
Extraction fan  
Shower stall with glass door with automatic sump pump  
Shower rose  
Mirror  
Fresh water flush toilet  
Toilet roll holder  
Towel rail

### SALOON & GALLEY

Tinted opening glass saloon windows  
Electric hot plate (2 x burner) cover and recessed  
Microwave -powered off inverter  
Refrigerator and Freezer (DC) underbench x 2  
Galley benchtop solid surface, stainless steel twin sink with single lever faucet  
Sink and cooktop cover recesses in benchtop  
Galley storage cabinets and soft close drawers  
Headliner in high quality vinyl  
LED lighting overhead 24v  
L-Shaped saloon lounge with timber table and storage  
Flooring high quality vinyl  
Blinds (selected from samples)

### INTERIOR

High quality vinyl flooring in saloon and companionways and cabins  
Vinyl headliner covered ceiling with wood trim design features  
Teak Timber satin finish



**INTEGRITY**  
MOTOR YACHTS

DISCOVER MORE

Version: 02/10/19

**340SEDAN 340SX 380SEDAN 380FB 380SX 440SEDAN 440FB 460SX 490GRANDSEDAN 510SX**

QUEENSLAND  
Integrity Motor Yachts  
Jason Kowalski 0416 057 326

NEW SOUTH WALES  
AWMarine Sales  
Adam Workman 0419 124 939

VICTORIA  
Pier 35 Boat Sales  
Terry Ryan 0422 666 212

WESTERN AUSTRALIA  
Martin Box Marine  
Phone 08 9336 1466

TASMANIA  
Boat Sales Tasmania  
Paul Nanscawen 0418 385 866

[www.integrityboats.com.au](http://www.integrityboats.com.au)

# THE INTEGRITY ADVANTAGE

There are a number of things that we believe make our boats leaders in their market. All of these features have been considered, designed and implemented to make your boating experiences more enjoyable. Introducing the integrity advantage.

## **CLASSIC STYLISH LINES WITH A CONTEMPORARY FEEL**

The inspiration for our range comes from the traditional cruising motor yacht, featuring timeless classic lines. We apply contemporary design elements to ensure our range have a striking on water appearance.

## **PROVEN DISPLACEMENT HULL WITH CLASS LEADING BEAM**

With a number of our boats having travelled many thousands of sea miles, the seakeeping abilities of our range is without question. The class leading beam ensures stability in all conditions, particularly when at rest. The displacement hull, greater beam, full length keel and additional weight ensures navigational stability in all seas or when at rest.

## **MINIMAL HULL SLAP**

A little thought about but very important feature, as anyone that has tried to sleep in a boat with water slapping under the hull knows is most annoying. Our boats have no planing strakes meaning no slap at rest.

## **SOLID HAND LAID FIBREGLASS HULLS FOR STRENGTH AND DURABILITY**

Our hulls are laid up to survey standard along with vinyl ester tie layers for strength, durability and osmosis protection. FGI Gelcoat is used on the exterior of the hulls especially applied to suit Australian conditions.

## **FULL LENGTH KEEL ENCASING THE PROPELLER AND RUDDER**

The full length keel assists with stability while offering protection to the propeller and rudder. Should you run aground, simply back off and continue your journey.

## **EASY TO HANDLE WITH EFFORTLESS DOCKING**

Bow and stern thrusters as standard on each model offer finger-tip control ensuring simple and easy berthing in all conditions. The helm door and through rail access makes

single handed step on - step off berthing a breeze. Side rail and stern access from the swim platform means marina and jetty access is safe and simple, no leaps of faith required.

## **360 DEGREE WIDE WALK AROUND DECK**

There is full easy access to all areas of the boat, with wide side decks and high bow, stern and hand rails ensuring safety for passengers and pets at anchor or underway.

## **LARGE SWIM PLATFORM**

The extensive swim platform features a sturdy deep water ladder, plus retractable hot and cold freshwater shower. Stainless stern rails can be added to house BBQ's or preparation boards, tenders and rod holders.

## **INNOVATIVE COCKPIT DESIGN**

The beamy cockpit layout features full wrap around padded seating with a drop down teak table, creating additional accommodation or a day bed along with under-seat storage and self-draining ice box. Combines with the large hopper window and door, spacious saloon and aft galley to create the ultimate entertaining layout. The ice box can also be converted to take a portable 55 or 75 litre Waeco fridge/freezer.

## **GENERATOR AND REVERSE CYCLE AIR-CONDITIONING**

Onan diesel powered generator offered standard allowing for all of your 240V electricity needs including coffee machine, toaster, juicer, hair dryer and more. Ducted air-conditioning is available offering cold and hot air during temperate or cooler climates.

## **LARGE STAINLESS STEEL HOPPER WINDOW AND DOOR**

Critical to creating the flowing cockpit, galley and saloon layout, the sturdy stainless steel hopper window and door is a trademark feature of our range. Each model benefits from this design trademark.



DISCOVER MORE

**340SEDAN 340SX 380SEDAN 380FB 380SX 440SEDAN 440FB 460SX 490GRANDSEDAN 510SX**

QUEENSLAND  
Integrity Motor Yachts  
Jason Kowalski 0416 057 326

NEW SOUTH WALES  
AWMarine Sales  
Adam Workman 0419 124 939

VICTORIA  
Pier 35 Boat Sales  
Terry Ryan 0422 666 212

WESTERN AUSTRALIA  
Martin Box Marine  
Phone 08 9336 1466

TASMANIA  
Boat Sales Tasmania  
Paul Nanscawen 0418 385 866

[www.integrityboats.com.au](http://www.integrityboats.com.au)

## WELL APPOINTED AFT GALLEY

---

Large fridges, double bowl sink with flick mixer, modern corian style bench tops, microwave and glass twin top hotplate are just the start. Considerable storage is a feature along with additional refrigeration options.

## SPACIOUS ACCOMMODATION

---

Recent design improvements have led to more spacious and roomy accommodation in the bedrooms, featuring full size comfortable island beds. The saloon and cockpit tables lower to create additional double bed accommodation across the range. Cedar lined full length cabinets ensure your clothing is stowed moisture and pest free.

## SEPARATE HEAD AND SHOWER COMPARTMENT

---

Rarely offered in boats of this size, a separate shower ensures little water splash throughout the bathroom and more room to enjoy your shower. Offers privacy for those using the shower or toilet.

## RELIABLE FUEL SUPPLY SYSTEM

---

Racor fuel filters with isolation taps are fitted to bypass blocked filters and reduce the chance of contaminated fuel. Separate ball valves are installed to assist the return or transfer of fuel, and sludge tanks with ball valves for ease of draining are included in the fuel tanks.

## LONG RANGE CRUISING WITH LARGE WATER AND FUEL CAPACITY

---

The long-range performance, economical and mechanical capabilities of our range is supported by considerable fresh water storage and saltwater wash down facilities. Large fuel tanks are also on board, with the option of adding a water maker to extend the cruising capability.

## INNOVATIVE ELECTRICAL SYSTEM MANAGEMENT WITH SOLAR

---

With advancements in solar capabilities and advanced power management systems, your Integrity when fitted with solar can operate for lengthy periods without the need for shore power or generator.

## FACTORY BACKED DEALER NETWORK

---

We maintain Independent Dealers in all major territories, offering full warranty and service support. We appreciate the opportunity to assist our owners with whatever little headaches may arise, and we never let them down.

## MORE THAN OWNING A BOAT

---

Rather than focusing on selling a product, we prefer to introduce our owners to the ultimate lifestyle experience. We offer a series of on-water and off-water events exclusive to those who purchase a boat from our range. Fully escorted trips allow our owners to expand their navigational and boating experiences in the company of other owners and our experienced team members.

## INVESTMENT IN A TRUSTED BRAND

---

Integrity Motor Yachts is the leading displacement motor yacht brand in Australia. With over 100 motor yachts sold and the backing of a dealer network, there's certainty in knowing you're investing in a known and well respected brand with strong resale value.

## PRODUCT ENHANCEMENTS

---

- Rudder locking pin
- Upgraded bow and stern thrusters on boats 38ft and larger
- Double hose clamps on all hoses
- 3000Va Inverter 70 Amp charger system with mains changeover
- Battery relocation for practicality
- 60 metres of anchor chain
- Fresh and salt water washdown taps in anchor well
- All AC outlets RCD protected
- Shore power inlet now protected in cockpit locker
- Fusion stereo/DVD with Bluetooth
- Stainless steel hatches



**340SEDAN 340SX 380SEDAN 380FB 380SX 440SEDAN 440FB 460SX 490GRANDSEDAN 510SX**

QUEENSLAND  
Integrity Motor Yachts  
Jason Kowalski 0416 057 326

NEW SOUTH WALES  
AWMarine Sales  
Adam Workman 0419 124 939

VICTORIA  
Pier 35 Boat Sales  
Terry Ryan 0422 666 212

WESTERN AUSTRALIA  
Martin Box Marine  
Phone 08 9336 1466

TASMANIA  
Boat Sales Tasmania  
Paul Nanscawen 0418 385 866

[www.integrityboats.com.au](http://www.integrityboats.com.au)